

HDP

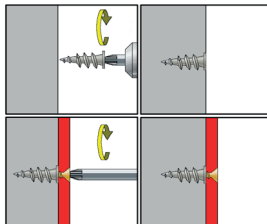

Special plug for use in **polysterene (isolation)**. Easy application by using manual or electric screwdrive. **Designed for light fixing**. Fixing material is fasten by chipboard or wood screws.

INSTALLATION:



APPLICATION

> polystyrene



MATERIAL

Polypropylene



ADVANTAGES

- > easy installation
- > fast installation
- > low price

TECHNICAL DATA:

Size	Anchor lenght	Screw \emptyset	Recommended loads
23x50	50	4-5	0,20

All figures are in mm

Recommended loads in kN (1 kN \approx 100 Kg)

POLYSTYRENE PLUGS

HDP

TRUHLÁŘ a spol., s.r.o.

Hlavní 812, 251 68 Hlubočinka, Czech Republic | tel.: +420 323 671 745 | fax: +420 323 671 744 | e-mail: export@ttt.cz

