

Turbo plugs TURBO

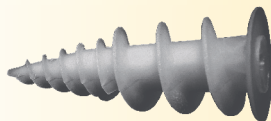

Special plug for application in gypsum plasterboard. Plug is easily installed to gypsum plasterboard without any special tool. The material is fixed with the chipboard or gypsum screw.

Application:

- gypsum plasterboard

Advantages:

- easy installation
- fast installation
- low price

Installation

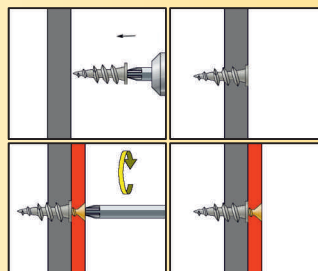

Material: Polyamide (Nylon) with glass

Type TURBO - Technical data and price

Size	Anchor lenght	Screw \varnothing	Recommended loads	Basic price / 100 pcs	
				box	bulk
10 x 35	35	3,5 - 4	0,15	3,00 €	2,70 €

All figures are in mm

Recommended loads in kN
(1 kN \cong 100 Kg)