

UPA

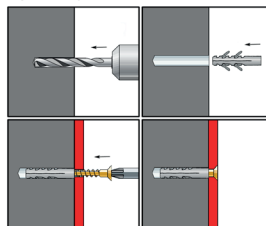

Lightweight all-purpose fixing for professional and DIY use. High quality Polyamide for optimal performance and easy application. Thermal resistance from $-40\text{ }^{\circ}\text{C}$ to $+100\text{ }^{\circ}\text{C}$.

INSTALLATION:



APPLICATION

- > concrete
- > brick
- > natural stone
- > sand-stone



MATERIAL

Polyamide PA6
(Nylon)



ADVANTAGES

- > wide area of application
- > high temperature resistance

TECHNICAL DATA:

Size	Drill \varnothing	Minimal drill depth	Anchor length	Screw \varnothing	Recommended loads (concrete)
4x20	4	25	20	2-3	0,13
5x25	5	30	25	2,5-4	0,32
6x30	6	35	30	3,5-5	0,53
7x35	7	40	35	4-5,5	0,65
8x40	8	45	40	4,5-6	0,75
10x50	10	55	50	6-8	0,92
10x60	10	65	60	6-8	0,92
12x60	12	65	60	8-10	1,33
14x75	14	80	75	10-12	1,76
16x90	16	95	90	12	2,90
16x100	16	105	100	12	2,90
16x120	16	125	120	12	2,90
16x140	16	145	140	12	2,90

All figures are in mm

Recommended loads in kN (1 kN \approx 100 Kg)

STANDARD PLUGS

UPA

TRUHLÁŘ a spol., s.r.o.

Hlavní 812, 251 68 Hlubočinka, Czech Republic | tel.: +420 323 671 745 | fax: +420 323 671 744 | e-mail: export@ttt.cz

