

Universal Anchors (Polyamide)

TX-PA



Plug for universal use made of Polyamide PA6 (TX-PA). It is held through internal pressure against the inside of the hole into solid materials and it is held in place by segments knotting behind the drill hole into the cavity.

Application:

- hollow or full brick
- gas concrete
- concrete
- sand-stone
- chipboard
- gypsum plasterboard

Advantages:

- high quality
- fast installation
- strong anchoring
- usage in many materials

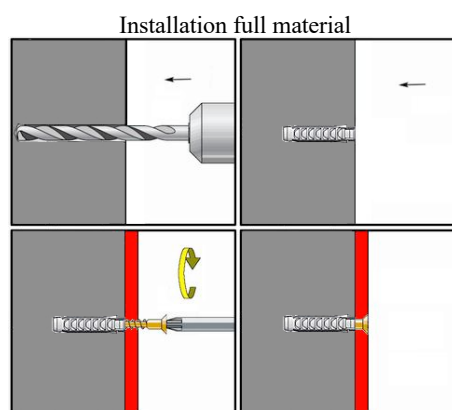
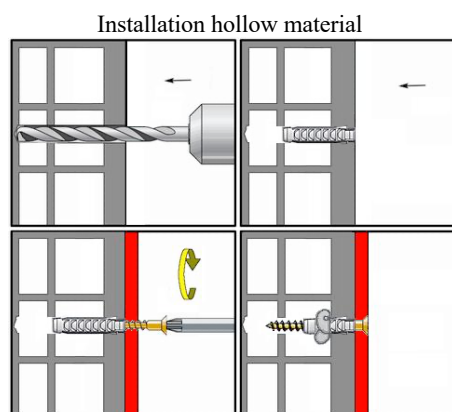

Material: Polyamide PA6 (Nylon)

Type TX-PA - Technical data and price

Size	Drill Ø	Minimal drill depth	Anchor length	Screw Ø	Recommended loads
5 x 25	5	35	25	3 - 4	0,60
6 x 30	6	40	30	4 - 5	0,70
6 x 50	6	60	50	4 - 5	0,70
8 x 40	8	50	40	4,5 - 6	1,10
8 x 60	8	70	60	4,5 - 6	1,10
10 x 50	10	70	50	6 - 8	1,50
10 x 70	10	90	70	6 - 8	1,50
12 x 60	12	80	60	8 - 10	1,70

All figures are in mm

Recommended loads in kN
(1 kN \cong 100 Kg)