

NH | NHZ

NHH

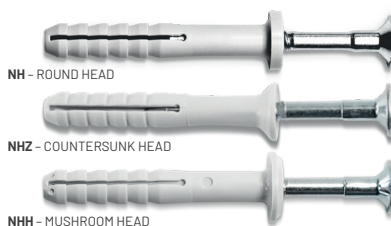

ONLY Ø 6 MM



NH - ROUND HEAD

NHZ - COUNTERSUNK HEAD

NHH - MUSHROOM HEAD

These plugs can be used for **quick installation in internal and external construction work**. Recommended where a **rapid and large numbers of fixing are required**. These plugs are available with round, countersunk and mushroom head.

INSTALLATION:

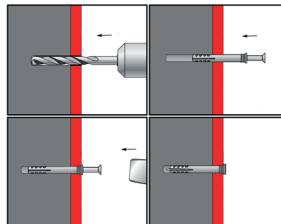

APPLICATION

- > concrete
- > stone
- > sand-stone



MATERIAL

Polyamide PA6
(Nylon)



ADVANTAGES

- > fast and easy installation
- > dismantling option

TECHNICAL DATA:

Size	Drill Ø	Minimal drill depth	Anchor length	Screw Ø	Collar Ø	Fixable thickness	Recommended loads
5×25	5	30	25	3,4	9	3	0,31
5×35	5	40	35	3,4	9	10	0,31
5×45	5	50	45	3,4	9	15	0,31
6×25	6	30	25	3,8	10	3	0,48
6×35	6	40	35	3,8	10	5	0,48
6×40	6	45	40	3,8	10	10	0,48
6×45	6	50	45	3,8	10	15	0,48
6×55	6	60	55	3,8	10	25	0,48
6×60	6	65	60	3,8	10	30	0,48
6×70	6	75	70	3,8	10	40	0,48
6×80	6	85	80	3,8	10	50	0,48
8×45	8	50	45	4,8	11	5	0,65
8×60	8	65	60	4,8	11	20	0,65
8×75	8	80	75	4,8	11	35	0,65
8×80	8	85	80	4,8	11	40	0,65
8×100	8	105	100	4,8	11	60	0,65
8×120	8	125	120	4,8	11	80	0,65
8×135	8	140	135	4,8	11	95	0,65

All figures are in mm

Recommended loads in kN (1 kN = 100 Kg)

NAIL PLUGS

NH, NHZ, NHH

TRUHLÁŘ a spol., s.r.o.

Hlavní 812, 251 68 Hlubočinka, Czech Republic | tel.: +420 323 671 745 | fax: +420 323 671 744 | e-mail: export@ttt.cz

