

UPA/L

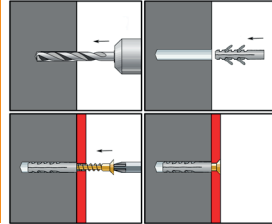

Lightweight all-purpose fixing for professional and DIY use. High quality Polyamide for optimal performance and easy application. Thermal resistance from $-40\text{ }^{\circ}\text{C}$ to $+100\text{ }^{\circ}\text{C}$.

INSTALLATION:



APPLICATION

- › concrete
- › brick
- › natural stone
- › sand-stone



MATERIAL

Polyamide PA6
(Nylon)



ADVANTAGES

- › wide area of application
- › high temperature resistance

TECHNICAL DATA:

Size	Drill \varnothing	Minimal drill depth	Anchor length	Screw \varnothing	Recommended loads (concrete)
5x25	5	30	25	2,5-4	0,32
6x30	6	35	30	3,5-5	0,53
8x40	8	45	40	4,5-6	0,75
10x50	10	55	50	6-8	0,92
12x60	12	65	60	8-10	1,33
14x75	14	80	75	10-12	1,76
16x90	16	95	90	12	2,90

All figures are in mm

Recommended loads in kN (1 kN = 100 Kg)



TRUHLÁŘ a spol., s.r.o.

Hlavní 812, 251 68 Hlubočinka, Czech Republic | tel.: +420 323 671 745 | fax: +420 323 671 744 | e-mail: export@ttt.cz